

# Cobolt o6-o1 Fiber pigtailed

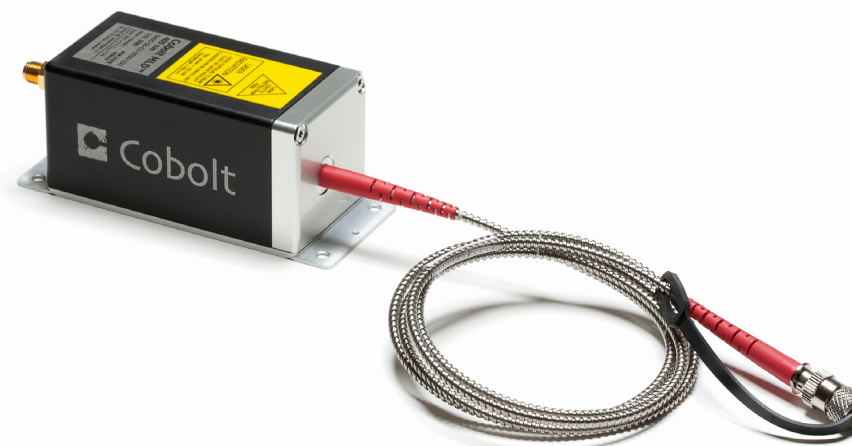

## True fiber pigtail for o6-o1 Series plug-and-play modulatable laser modules

- Easy-to-integrate compact and powerful laser modules
- SM/PM fiber
- Stable output over time and various temperature conditions
- Insensitive to transport conditions
- 405 nm, 488 nm, 638 nm and 660 nm

The Cobolt o6-o1 Series lasers can be supplied with an ultra-compact and robust fiber delivery option.

A true fiber pigtail option for high performance laser diode modules, where the fiber is permanently aligned and fixed inside the sealed package using Cobolt proprietary HT-Cure™ Technology, providing stable output over a large temperature range and high level of insensitivity to transport conditions.

The design is intended for OEM use and type of fiber, connector and lengths can be customized. The coupling efficiency (into SM/PM fiber) is typically 75 %, but output power is specified as out of the fiber.

## Cobolt o6-o1 Fiber Pgtailed Option

	405 nm	488 nm	638 nm	660 nm
	MLD	MLD	MLD	MLD
Wavelength in air (nm)	405 ± 5	488 ± 5	638 ± 5	660 ± 5
Spectral Linewidth (FWHM)	< 1.2 nm			
Maximum Power (mW) - Out of fiber	50	30	75	75
Long-term stability (8 hrs ± 3°C)	< 2%			
Numerical Aperture (NA)	0.07	0.08	0.09	
Fiber Output	FC/APC, 8°, non-collimated			
Fiber Type	SM/PM			
Polarization	PER > 100:1, ± 2°			
Standard Fiber Length	1 (m)			
Jacketing	Ø 3mm, Stainless Steel			
Modulation				
Digital modulation				
Bandwidth	DC - 150 MHz			
Extinction ratio @10 MHz	>10 000 000 : 1 (>70dB)			
Rise/fall time	< 2.5 ns			
Digital modulation				
Bandwidth	DC - 2 MHz			
Extinction ratio @250 kHz	>10 000 000 : 1 (>70dB)			
Rise/fall time	< 300 ns			
Digital modulation				
Bandwidth	DC - 500 kHz			
Extinction ratio	inf : 1			
Rise/fall time	< 300 ns			
Total system power consumption	< 10 W			
Maximum laser head baseplate temp.	50 °C			
Communication	RS-232 or USB			
Model number structure	wavel-o6-03-pwr-100 (CDRH/CE :Key control box included)			
	wavel-o6-03-pwr-200 OEM (auto-start mode)			
Warranty	12 months, unlimited hours of operation			

Laser performance specifications not in this datasheet can be found on the Cobolt o6-o1 Series datasheet.



HTCure™ is a Cobolt proprietary technology for manufacturing of ultra-robust and reliable laser sources, allowing Cobolt to offer market leading warranty terms. Lasers built using HTCure™ Technology have shown to withstand 60G mechanical shocks in operation as well as extreme storage temperature shocks (-30 to >100 degC) without any sign of degraded performance.



Fiber Pigtailed MLD

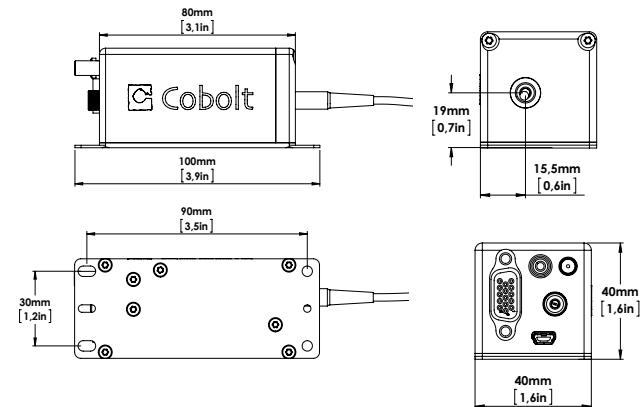

Key Box

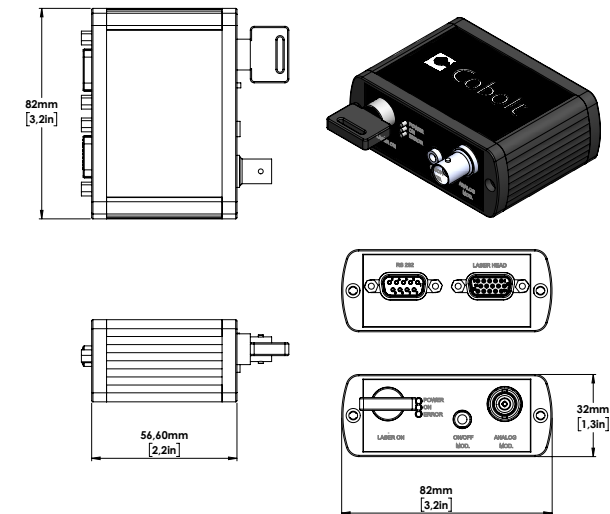

### Options & Accessories

- Laser head heat sink
- Control box with key-switch for CDRH operation